

Begane grond Peil=0 (1:50)

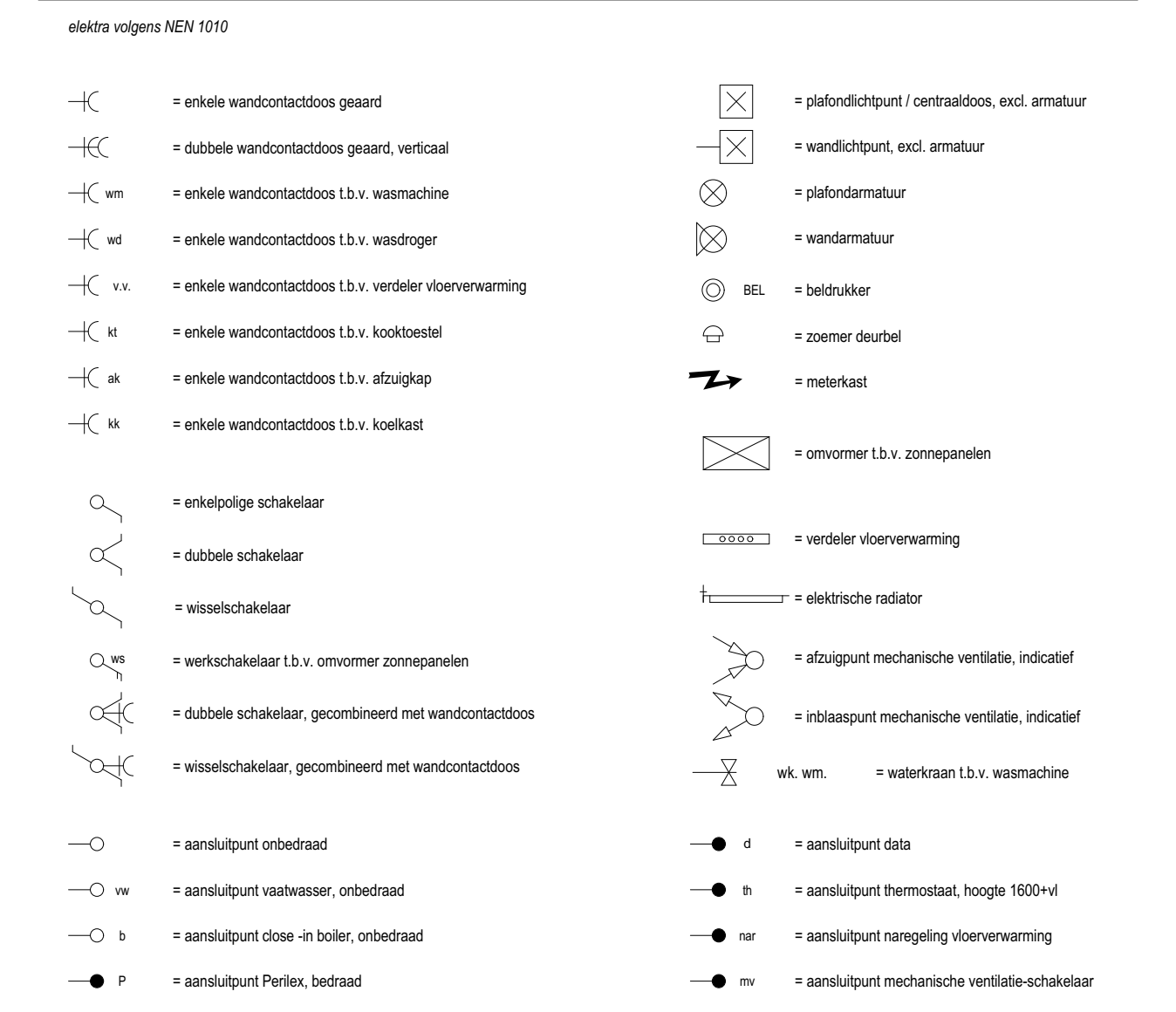

1e Verdieping +2920 (1:50)

Renvoer electra, installaties



Renvoer algemeen

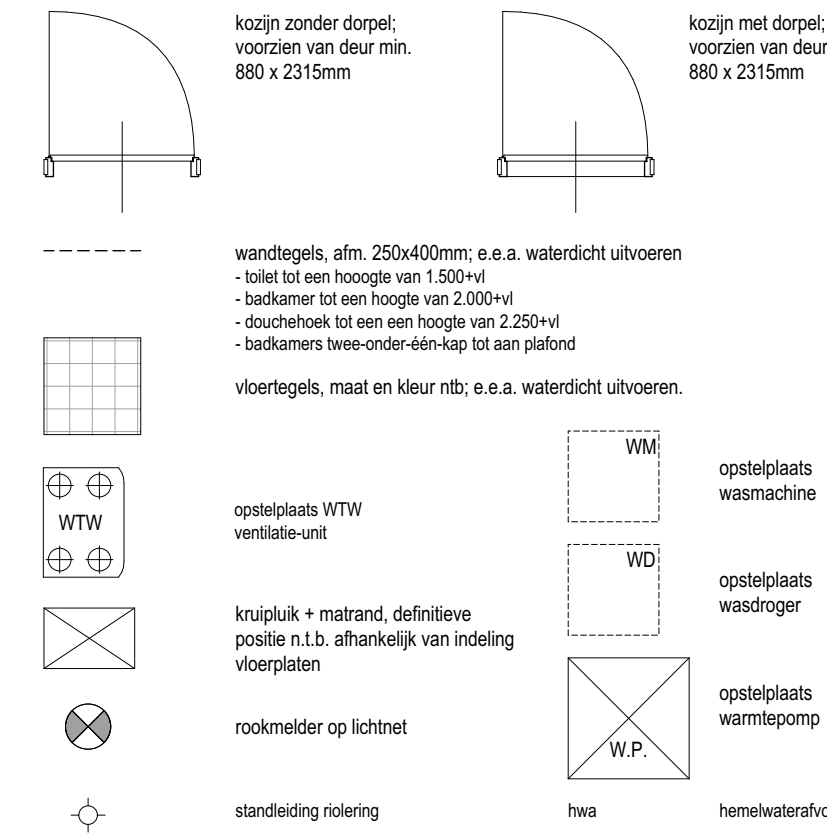

Renvoer materialen

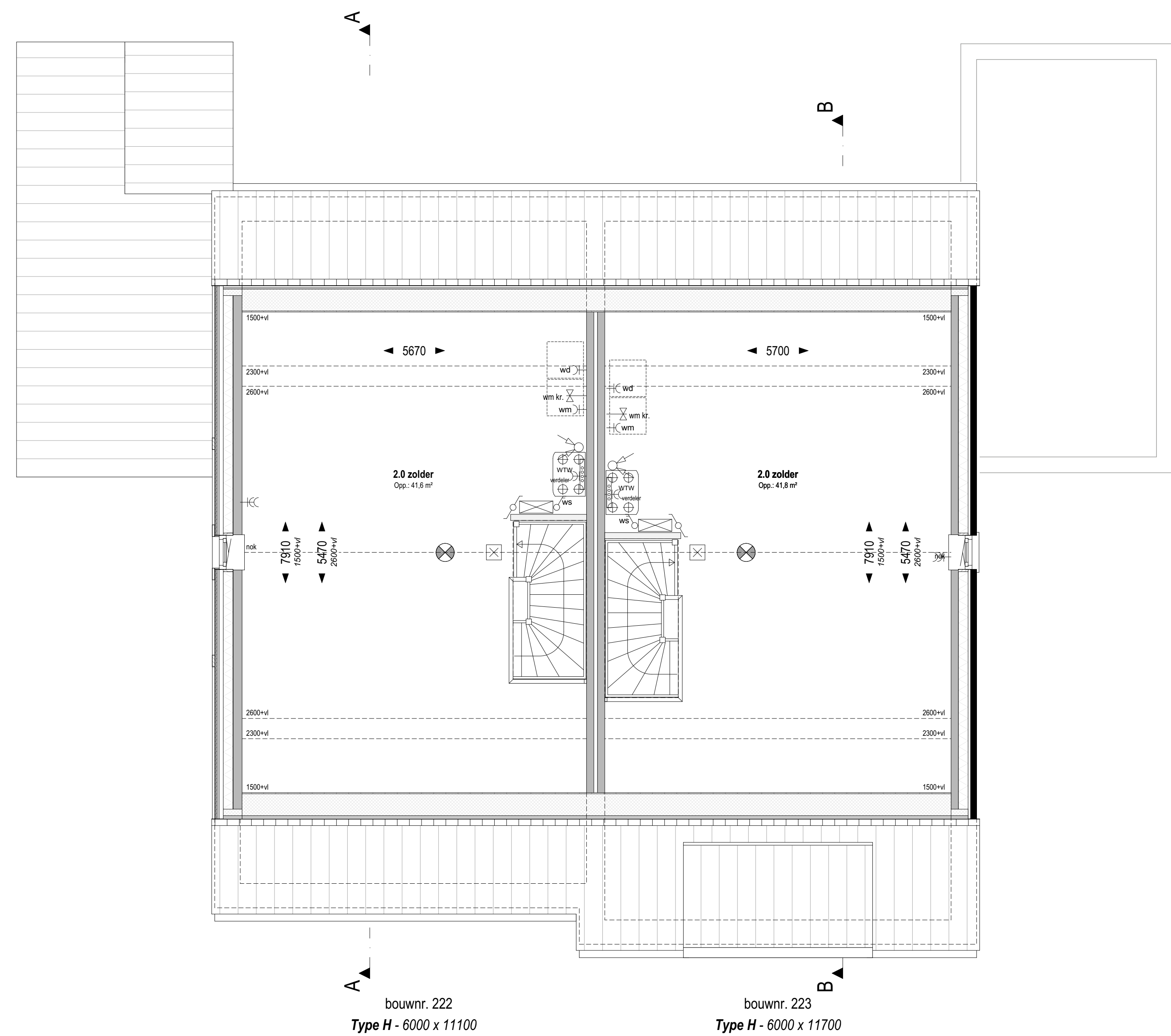
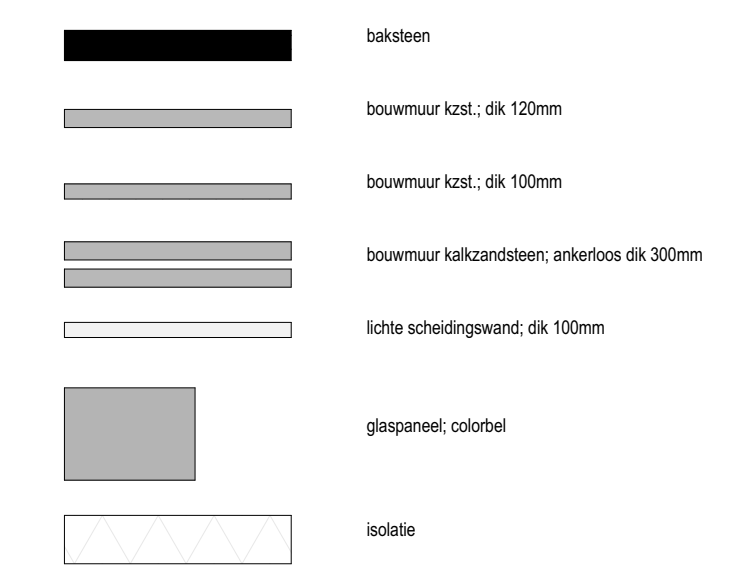

Zolder +5840 (1:50)

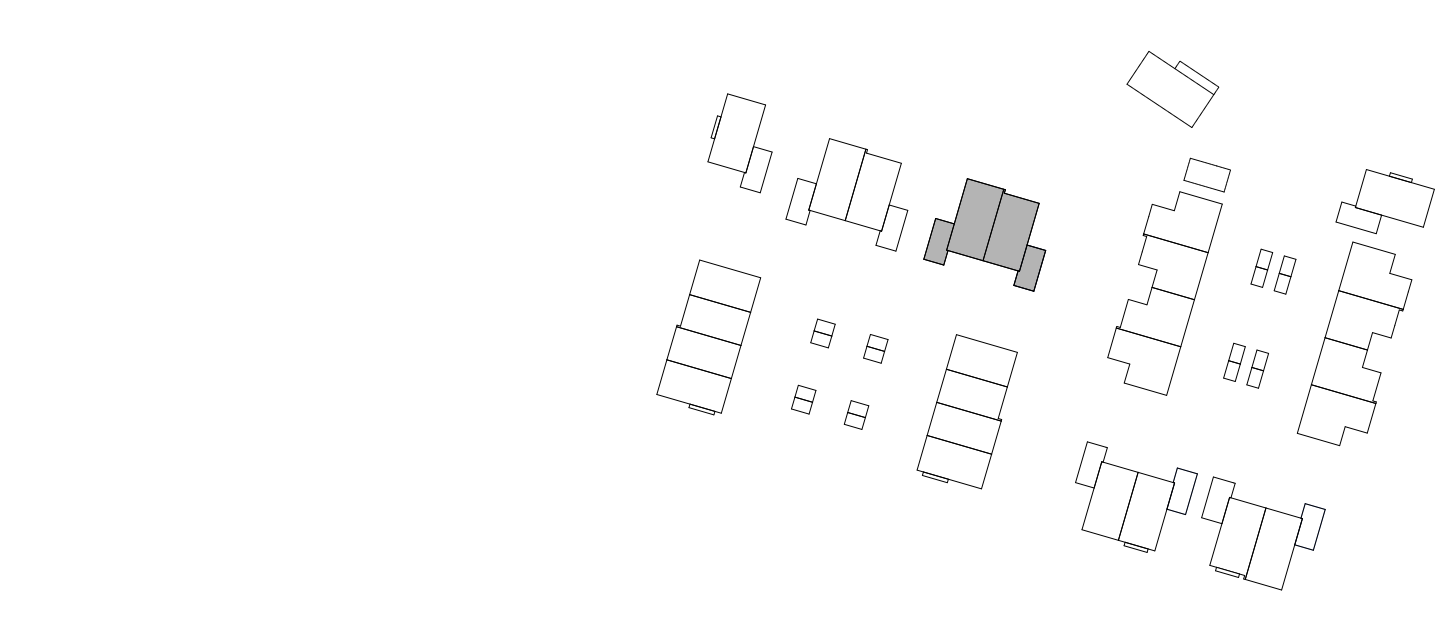
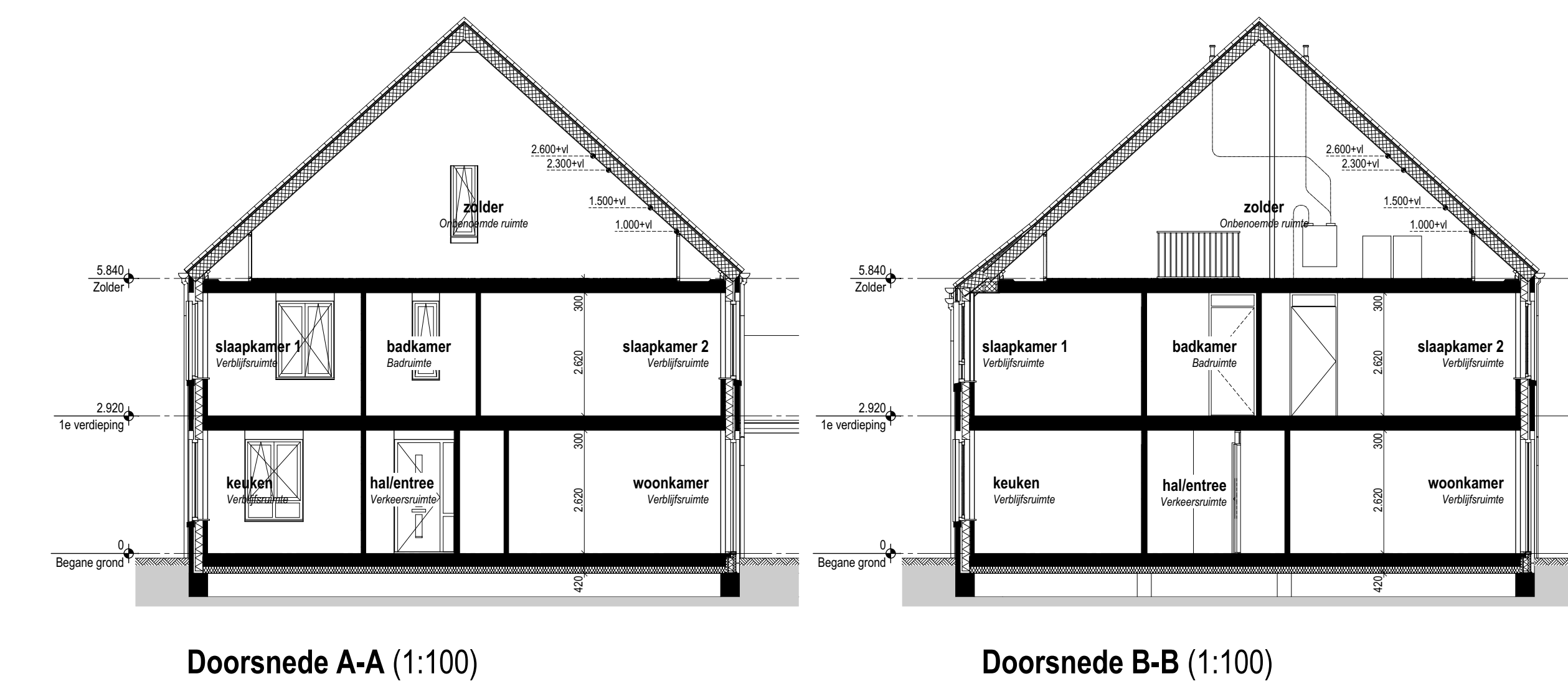

weusten liedenbaum architecten Project "Hoog Dalem", deelplan D2, Populier - Gorinchem Opdrachtgever V.O.F. Ooster-Linge 2		Project nummer 19-2073
Onderdeel Plattegronden gevels en drsn BLOK K - bwnr 222 en 223	Datum 13-08-2021	Status Definitief
Uitschetsing 167 6872 AC Arnhem 026 443 6972 info@weustenliedenbaum.nl www.weustenliedenbaum.nl	Wijziging A Wijziging B Wijziging D Wijziging E Wijziging F	Schaal 1:100, 1:50 Tekening nummer 1:100, 1:50 VK - 114